

BEAUTY AND THE BEAST

CHANDELIER - AIR CYLINDER MOUNTING BRACKET 1

DWG DESCRIPTION:
1"X1" 16 GAUGE STEEL TUBE, 1 1/2" X 1/2" X 1/8" ANGLE IRON, AND CLAMPS.

DIRECTOR: Kate Bryer
DESIGNER: Samina Vieth
TD: Elise Masur
DATE: 8/24/2016 REV #: REV#

811

DWG BY EVM

SCALE AS SHOWN

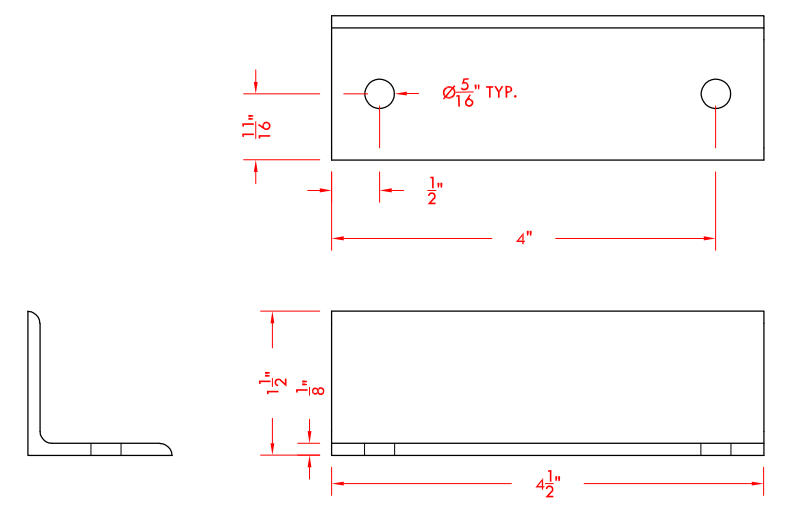

1
811 MOUNTING BRACKET 1 - ANGLE IRONS 6 = 1'-0"
- MAKE 4
- GRIND CORNERS AND EDGES

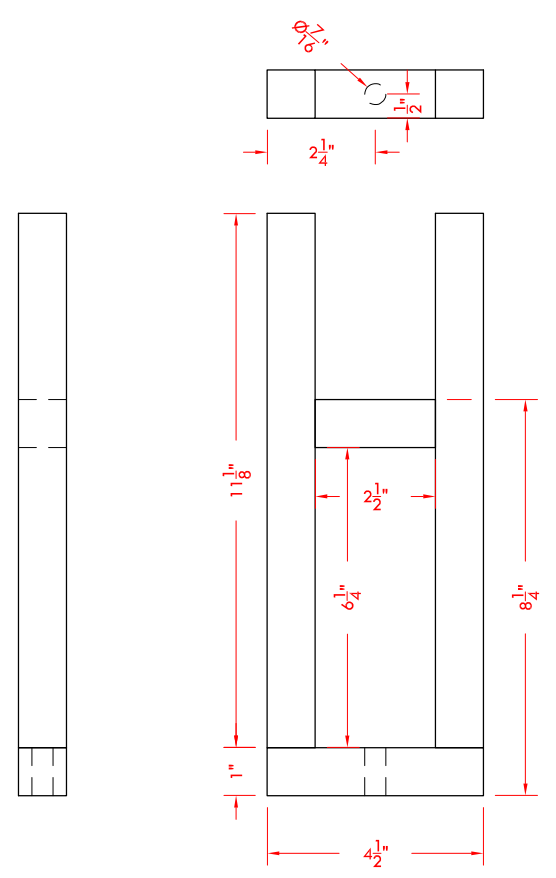

2
811 MOUNTING BRACKET 1 - STEEL TUBE 3 = 1'-0"
- MAKE 1
- GRIND ALL SURFACE WELDS

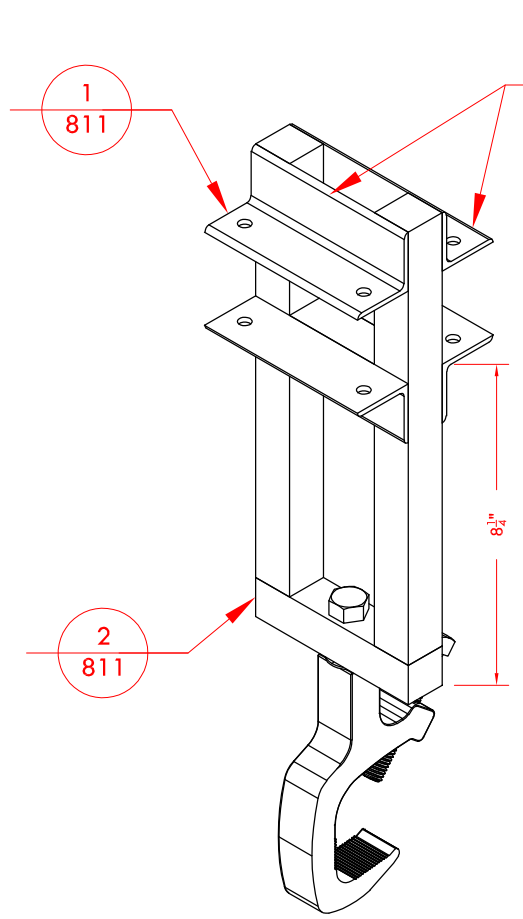

☆☆☆
DO NOT WELD
THE TOP TWO
ANGLE IRONS
IN PLACE. THEY
MUST BE
COMPLETELY
REMOVABLE.

SCALE 3" = 1'-0"

NOTES:
- **MAKE 1.**
- HOLE SIZES ARE INTENTIONAL. PLEASE DO NOT ALTER.
- GRIND ALL SURFACE WELDS.
- SEE ELISE WITH QUESTIONS.

CUT LIST
- 1X1
-- 2 @ 0'-11 1/8"
-- 1 @ 0'-2 1/2"
-- 1 @ 0'-4 1/2" (WITH A 7/8" DIA HOLE IN THE CENTER)
- ANGLE IRON
-- 4 @ 0'-4 1/2" (EACH WITH TWO 5/16" DIA HOLES SPACED ACCORDING TO DWG.)