

**PANEL 3  
PANEL DETAIL**

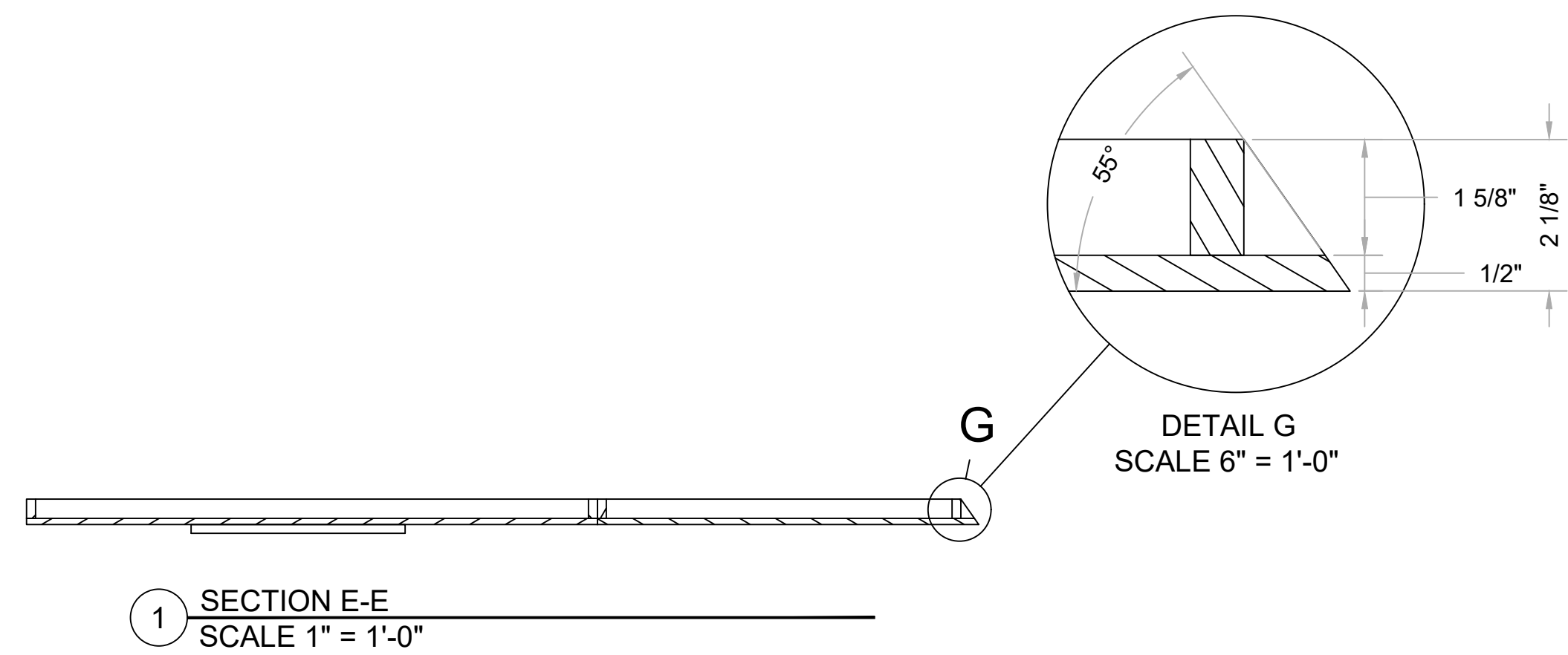

MCM# 92105A410 - Flanged threaded inserts (5/16"-18 x .486" long) for attaching Gyford standoffs

Panel is plywood construction; 1/2" MDO skin, Formica 909-58 Black laminated finish on face; printed vinyl overlay graphics to be applied on-site

Wooden French cleat for mounting flip book shelf

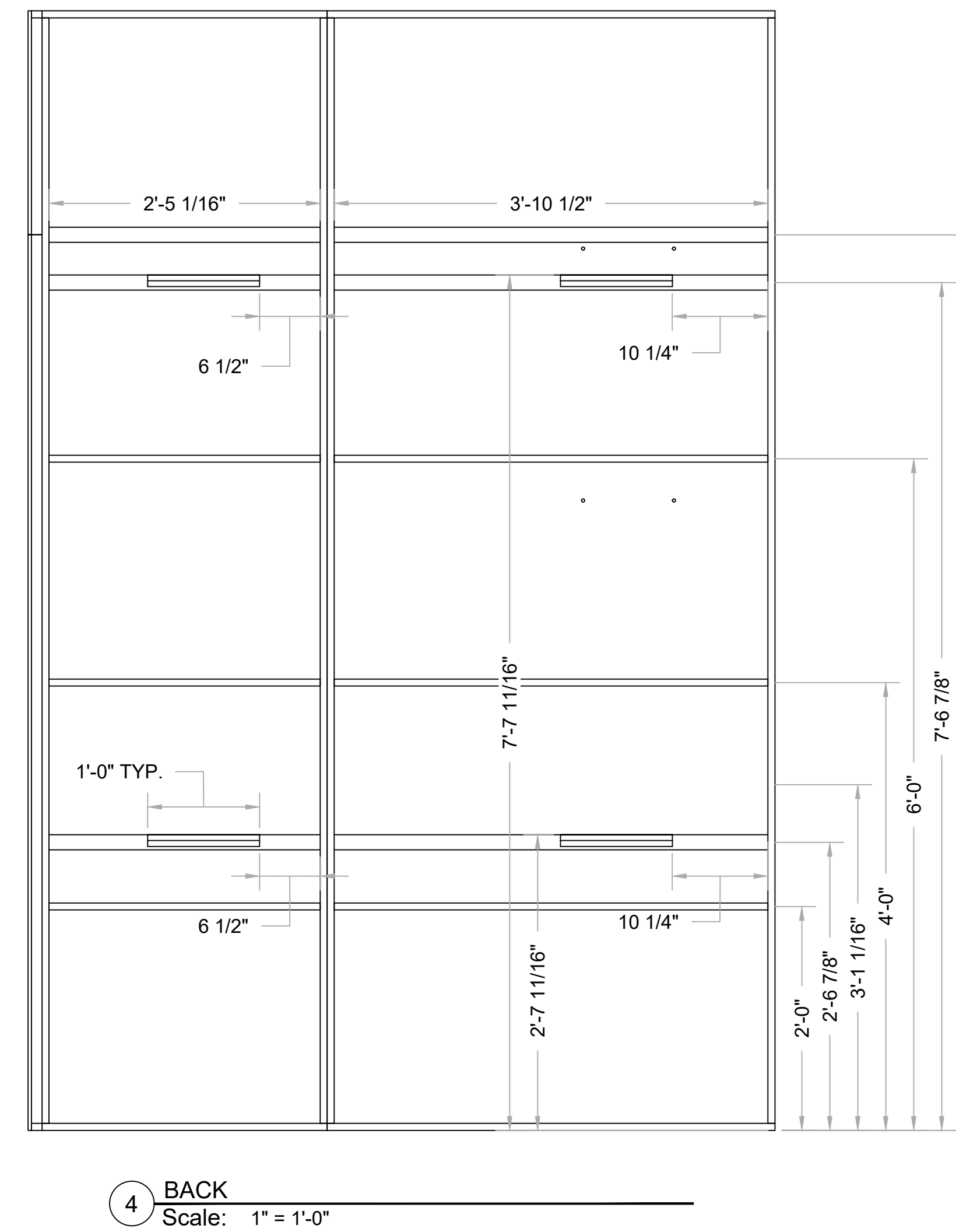
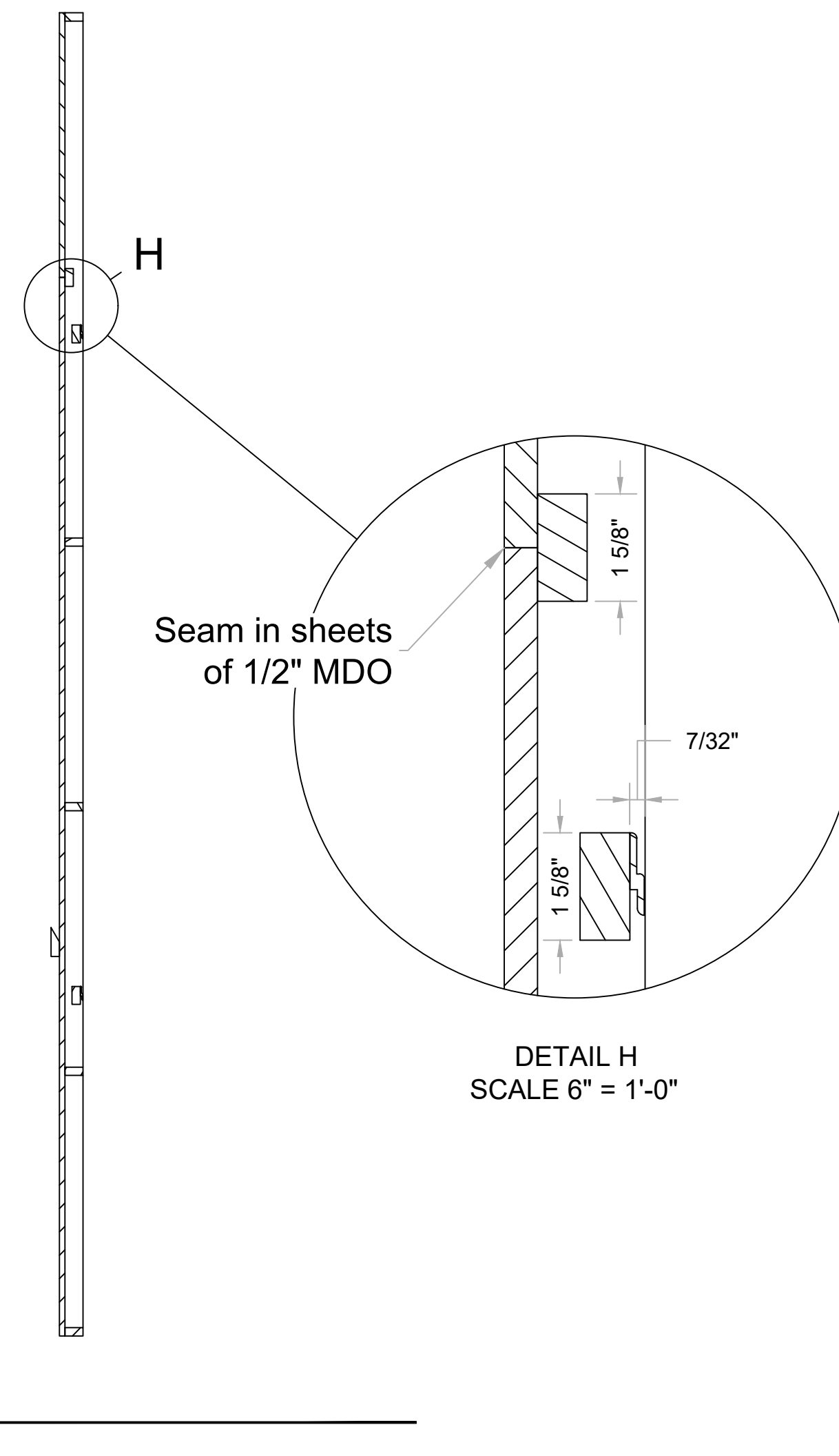
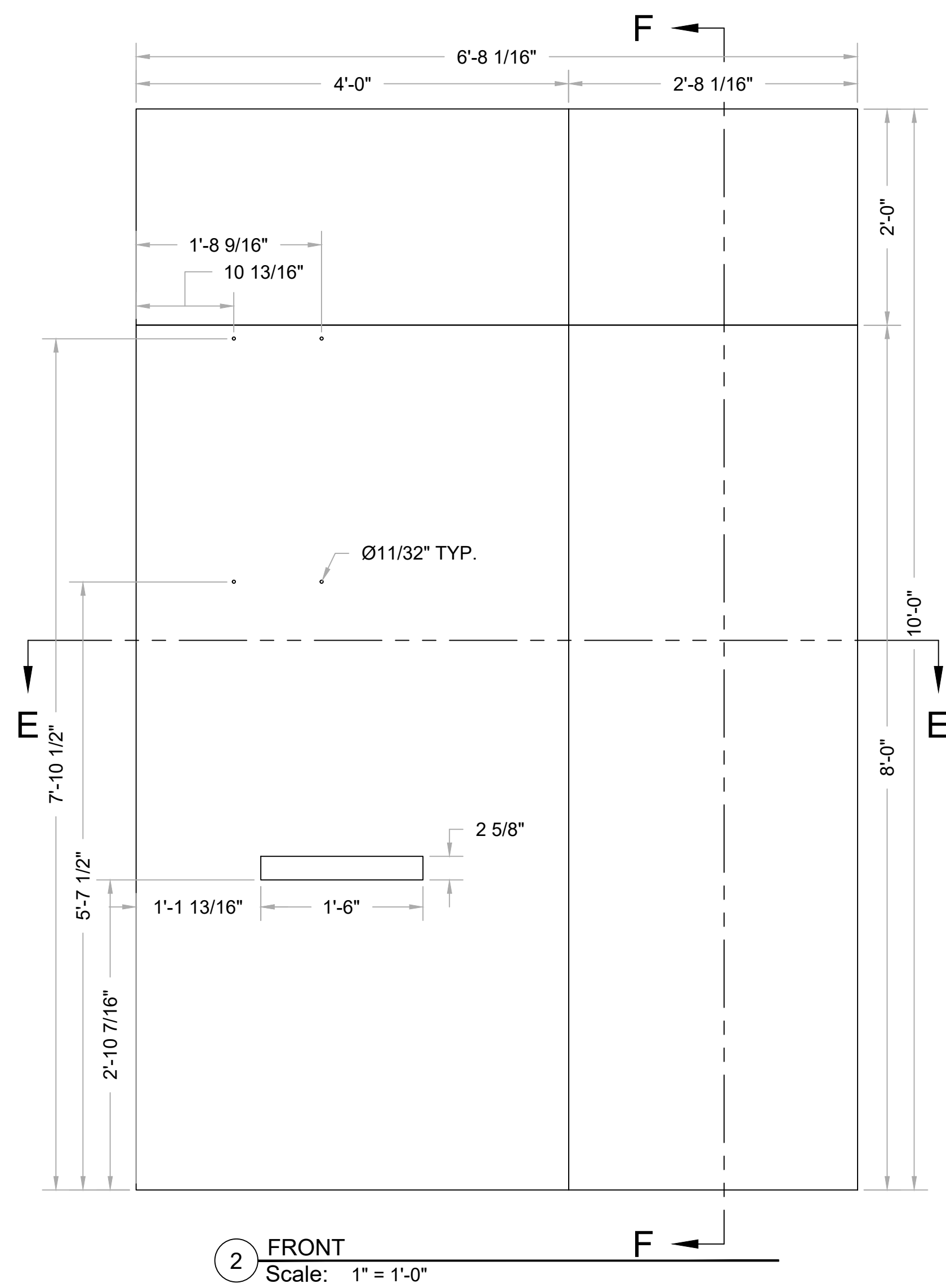
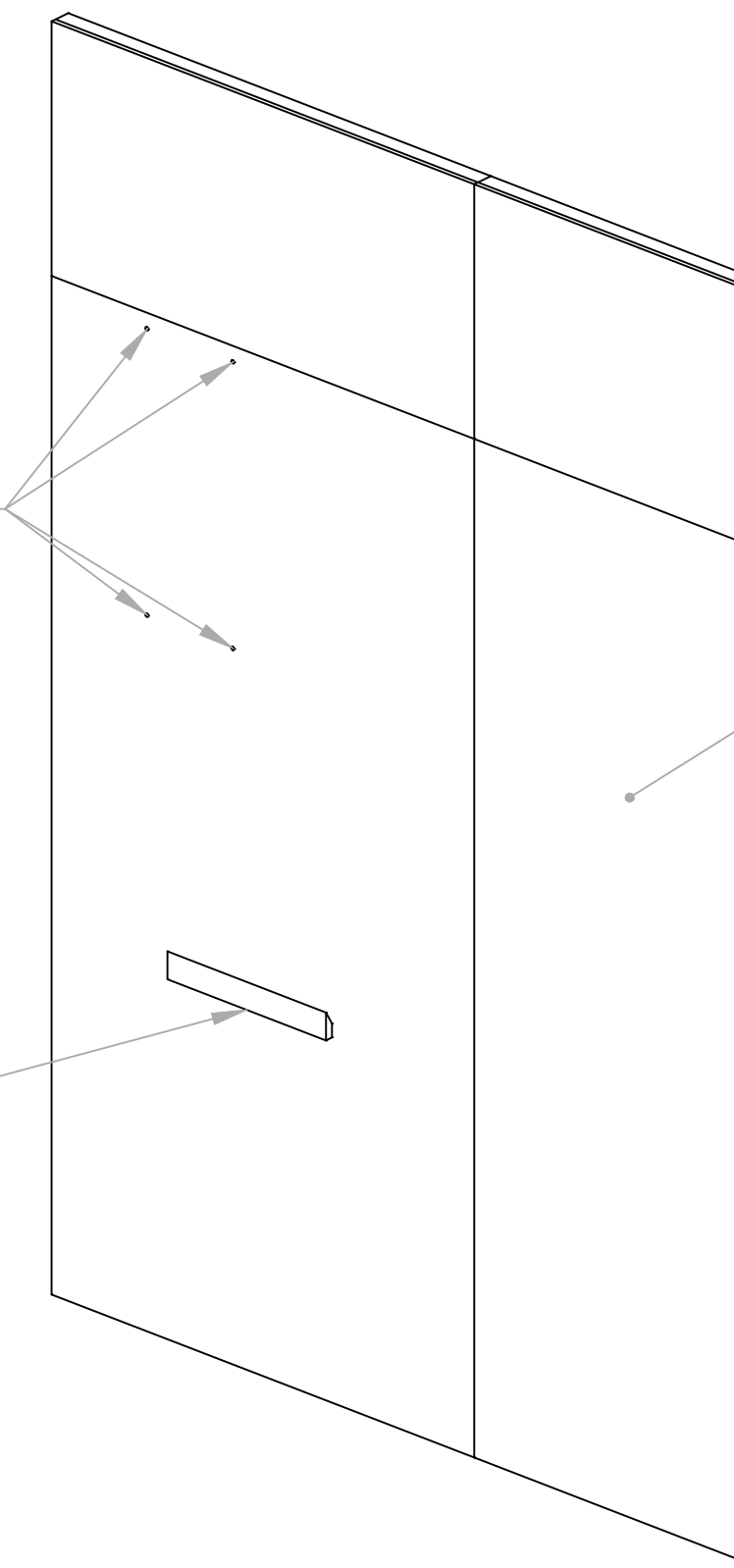

**ATTENTION!!!**  
Dimensions taken from bottom of wall to mid-points of framing members